

SA-TMS_IR5_B-000

TMS sensor with integrated IR array

Pressure measurement		
Range	800 to 9000	mbarA
Accuracy	±20	mbar
Resolution	4	mbar
Max proof pressure	9	barA
Inner liner temperature measurement		
Range	0 to +200	°C
Measurement	Default: 5 channels out of 14 Option: all 14 channels (HD)	
Sensitive element	Thermopile with Silicon Lens	
Wave length	8 to 14	µm
Accuracy	See §Accuracy	%FS
Calibrator	ECN100 N12 (e=1)	
Resolution	0.1	°C
Rim temperature measurement		
Range	0 to +150	°C
Measurement	1 channel by contact pad	
Accuracy	±0.3	°C
Resolution	0.1	°C
Air temperature measurement		
Range	0 to 130	°C
Accuracy	±0.3	°C
Resolution	0.1	°C
Internal temperature measurement		
Range	0 to 110	°C
Accuracy	0 to 85°C	±0.5 °C
	85 to 110°C	±5 °C
Resolution	0.1	°C
Relative humidity Measurement		
Accuracy	±2	%RH
Resolution	0.1	%RH
RF features		
RF frequency	433	MHz
RF emission power	8	dBm

Electrical features			
Battery rating voltage	3.6		V
Battery capacity @25°C	400		mAh
Max current consumption @25°C	Production storage	2	µA
	Stationary cold mode (10 second period)	40	µA
	Stationary hot mode (10 second period)	180	µA
	Moving mode (1Hz)	1.8	mA
	Transient mode (2Hz)	3.5	mA
Common features			
Dimensions (without valve)	64x23x18.2		mm
Material	Peek		
Weight (with battery, without valve)	24±2		g
Protection	IP42		
Vibration test	20Gpp 5'		
Shock	500		G
Operating Temp	-20 to +125		°C
Storage Temp	-40 to +85		°C

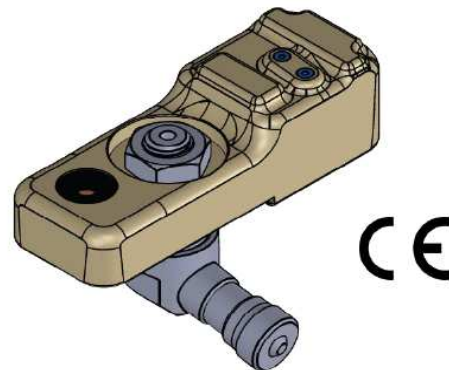

Mechanical drawing

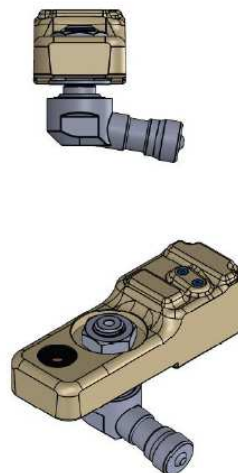
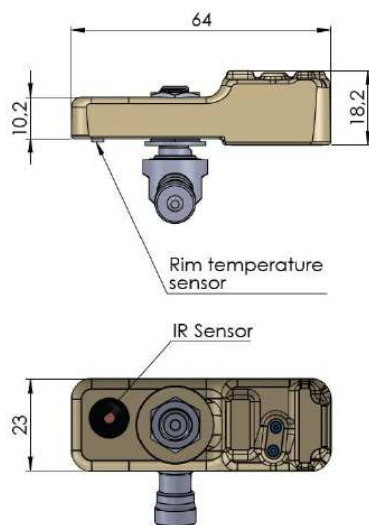

SA-TMS_IR5_B-000

TMS sensor with integrated IR array

Valve options

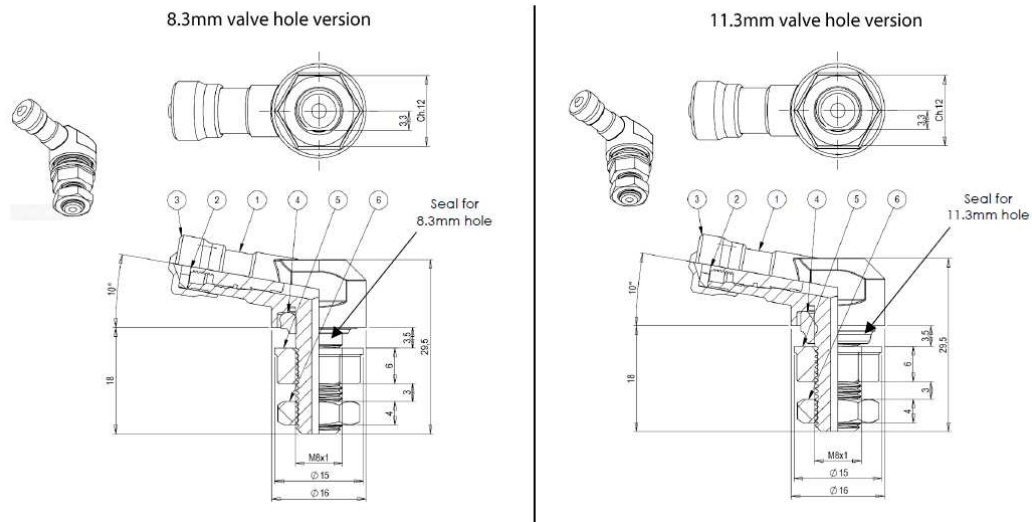

IR sensor accuracy

Accuracy table (% FS)						
Target T°C \ Ambient T°C	25	50	90	130	170	200
25	1	1	1	1	1	1
40	1	1	1	1	1	1
60	2	1	1	1	1	1
80	2	1	1	1	1	1
100	2	1.5	1	1	1	1
120	2	2	2	2	2	2

Available IR spots

